

GLASSGO-S

GlassGo-S is a glass turnstile intended for inside application with the requirement of access control system integration. This motorized pedestrian blades combined of glass and stainless steel design elements. As an outcome, we have space and cost saving product of aesthetic performance.

The peculiarities of this model are blades of solid glass, LED lane light, RGB indication of pass at bottom doorstep and presence of sensors that detect an attempt of human motion in the wrong way pass.

FULL-HEIGHT TURNSTILE



*GLASSGO TURNSTILE IS A COMBINATION
OF RELIABLE SECURITY AND STYLISH DESIGN*

 **630**
mm
PASSAGE WIDTH

 **20**
pers./min
SINGLE ACCESS

 **30**
pers./min
FREE ACCESS

 **IP 41**
PROTECTIVE LEVEL

 **BI-DIRECTIONAL**



Key advantages:

- Works on the principle of a classic full-height turnstile, however elegant side blades rotor are made of impact-resistant glass
- Low noise system operation
- Successful combination of affordable price and high quality
- Wide range of accessories
- Steadfast housing suitable for high traffic areas
- Can be integrated with any type of access control systems
- Low power consumption
- Wired remote control panel is in a standard kit
- In case of power failure, fail-secure by default (rotor locked in both directions);

Options:

- Any access control systems upon request (e.g. passage counter, RFID/Proximity/BioMetric readers, coin acceptor, push button, barcode and QR-code reader)
- OEM / logo application
- Lane light
- LED-display of the mode on the board
- Fail-safe mode under request
- RGB indication of pass at bottom doorstep
- Passage detection sensors in an unauthorised direction
- Sound alarm at attempt to pass in an unauthorized direction

Controlled by:

-  access control system;
-  manual control

When power goes OFF both directions are locked.

Electrical Specifications:

- Voltage:
 - from the AC (100-240)V, 50/60Hz;
 - from a DC source 12 V;
- Maximum power consumption 155W per pass.



www.tiso.global
+380 (44) 291-21-11
e-mail: sales@tiso.global



Technical Specifications:

Angle between blades	Y-type / 120°
Unit width, mm	1442
Unit length, mm	1442
Unit height, mm	2306
Passage width, mm	630
Mechanism	StrongLock-Servo
MCBF	10 000 000 cycles
Standard housing	Brushed SS AISI 304
Available housing	Brushed SS AISI 316
	Polished SS AISI 304
	Polished SS AISI 316
	Powder coated RAL

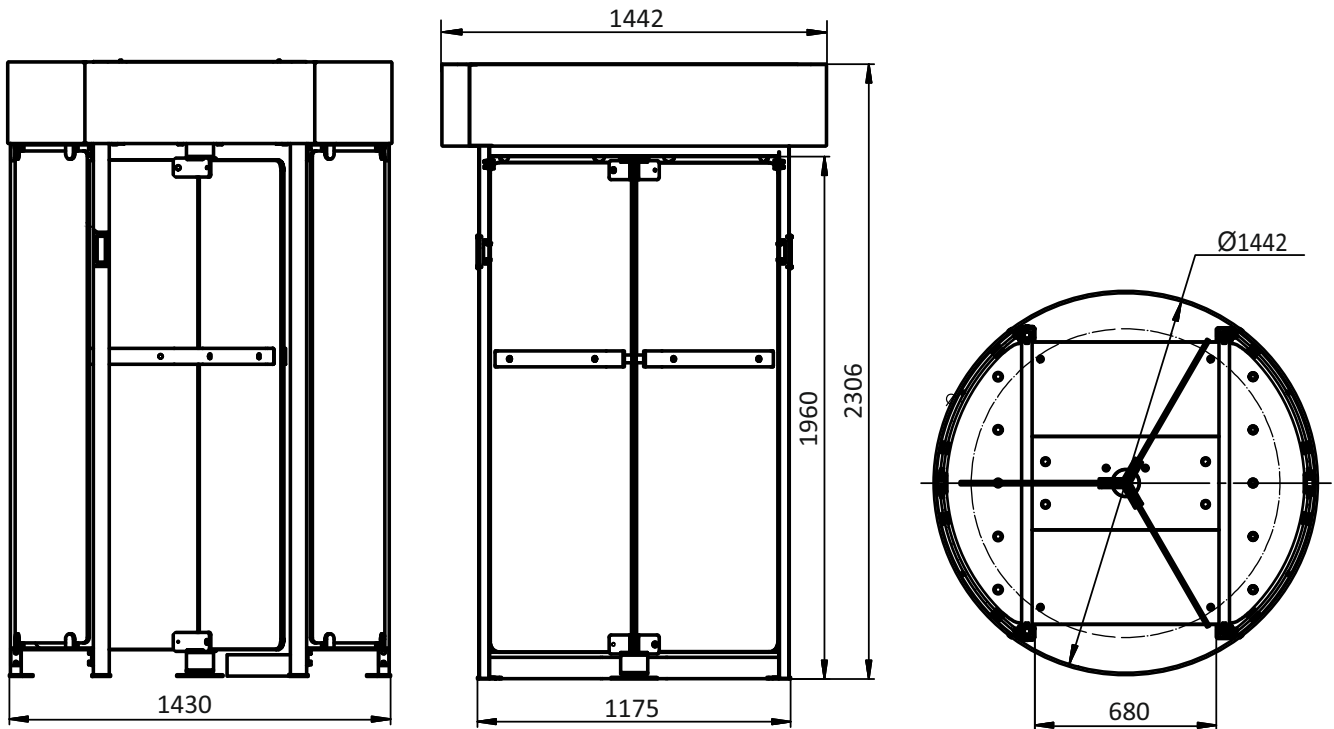

Recommended installation areas:

- Governmental Institutions
- Recreation areas
- Sport Complexes
- Commercial areas
- Production sites (Industrial Plants)
- Education Institutions
- Enterprises
- Urban areas
- Financial Institutions and others



www.tiso.global
 +380 (44) 291-21-11
 e-mail: sales@tiso.global

